



## Schraubenverbinder

## Screw Connector

Nut 5, 6, 8, 12

**Beschreibung** zur Verbindung von zwei Aluminiumprofilen, Zähne brechen die Eloxalschicht auf und schaffen eine sichere, elektrostatisch ableitfähige Verbindung

**Material** Stahl, verzinkt / Edelstahl

**Liefereinheit** 100 Stück

Slot 5, 6, 8, 12

**Description** To connect two aluminum profiles; penetrates the anodized coat of the profile - thus ensuring a safe, electrostatically conductive connection

**Material** Zinc plated steel / stainless steel

**Pack Quantity** 100 pieces

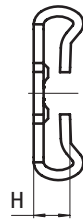
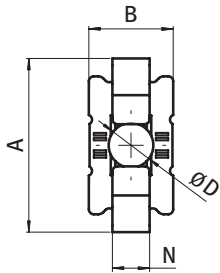

Ausführung Version	Extras Specials	A x B [mm]	D [mm]	H [mm]	N	Gewicht [g] Weight [g]	Stahl, verzinkt Zinc Plated Steel	Edelstahl Stainless Steel
		19.0 x 10.0	5.5	4.4	5	1.8	<a href="#">092038</a>	-
		27.5 x 13.0	6.5	7.3	6	5.4	<a href="#">092039</a>	-
		35.0 x 17.0	9.0	10.0	8	10.6	<a href="#">092040</a>	<a href="#">092040E</a>
		55.0 x 26.0	13.0	10.0	12	37.0	<a href="#">092040N12</a>	-
inkl. Linsenkopfschraube With pan-head screw		19.0 x 10.0	5.5	4.4	5	5.0	<a href="#">099F0520M05</a>	-
		27.5 x 13.0	6.5	7.3	6	9.0	<a href="#">099F0630M06</a>	-
		35.0 x 17.0	9.0	10.0	8	20.7	<a href="#">099F0840M08</a>	<a href="#">099F0840M08E</a>
inkl. selbstformende Schraube S7 x 25 With self forming screw S7 x 25		35.0 x 17.0	9.0	10.0	8	21.0	<a href="#">099F0840S07</a>	<b>I</b>
inkl. selbstformende Schraube S8 x 25 With self forming screw S8 x 25		35.0 x 17.0	9.0	10.0	8	21.0	<a href="#">099F0840S08</a>	<b>B</b>

